

This catalog covers:
FE250D-□G81

This fig. covers:
TITLE

PARTS CATALOG

4-STROKE ENGINE

FE290D

PRODUCT CODE	NOTE
FE290D—BG80	TILLER

This catalog covers:

FE290D- □ G80

This fig. covers:

PART NAME INDEX

AIR-FILTER/MUFFLER.....	09
CARBURETOR.....	08
CONTROL-EQUIPMENT.....	07
COOLING-EQUIPMENT.....	05
CYLINDER/CRANKCASE.....	01
ELECTRIC-EQUIPMENT.....	06
FUEL-TANK/FUEL-VALVE.....	10
LABEL.....	12
LUBRICATION-EQUIPMENT.....	04
PISTON/CRANKSHAFT.....	02
STARTER.....	11
TOOL.....	13
VALVE/CAMSHAFT.....	03

PARTS CATALOG INTRODUCTION

This parts catalog lists parts and sub-assemblies provided as service parts.

When it becomes necessary to replace parts, always use KAWASAKI GENUINE PARTS which have passed strict inspection which guarantees quality and performance.

1. HOW TO ORDER PARTS

- When ordering the parts, be sure to use the parts catalog corresponding to the product code. Check the product revision codes on the product and the catalog.
 Product Code (example) : FA130D-AA00
 Product Revision Code
- Specify the part code (all digits) exactly as listed in this catalog on your parts order.
- The parts not shown in the illustrations of this catalog are not sold separately; only the complete units or next higher assemblies illustrated are supplied as the service parts.

2. EXPLANATION OF PARTS CATALOG FORMAT

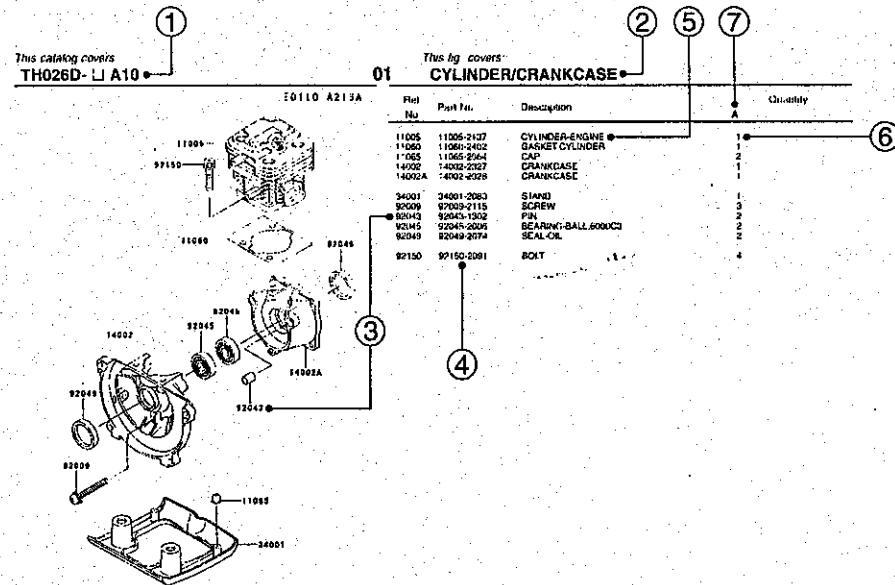

1) Product Code

This code describes the product code covered by this catalog. The product revision code, which is a part of the product code, is omitted.

2) Part Group Title

This title is the representative name for the group of parts illustrated on the page.

3) Reference Number

The reference numbers are shown on the illustration and the list as the link between them.

PARTS LIST INFORMATION

4) Part Number

This is the key of your parts ordering.

Three kinds of part number are used in this catalog.

a. Structure 1

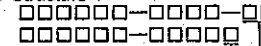

Part Revision Code

b. Structure 2

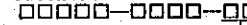

Color Code for Painted Part

c. Standard Hardware Number

(for bolts, nuts, washer, or the like)

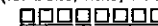

Size Code

Material and Surface Treatment Code

Item Code

5) Description and Additional Information

The part name, the location, the size, and the serial number as additional information, etc. are described here. Use them to find out and check the part required.

When a part number is changed without change of the product revision code and the changed parts are not interchangeable, the serial number of the product is noted as follows;

- (- FA130 - 100001) : Affected units are from beginning of the product of the product code up to and including this serial number.
- (FA130 - 100002 -) : Affected units are from this serial number and above.
- (FA130 - 100002 - FA130 - 110001) : Affected units are in this serial number range.

6) Quantity

The figure shows quantity of the part required at the indicated position on the illustration and for the specified product revision code.

The asterisk (*) on this column means the part can be used as the substitute on the product and is supplied until the stock is exhausted.

Note: Some small parts will be supplied by units.

Example: If six (6) bolts are ordered and the minimum quantity per unit is five (5), two (2), units of the bolt will be delivered.

7) Product Revision Code

This Code indicates an important change which affects the service parts interchangeability.

3. ABBREVIATIONS

#.....	Number	FR.....	Front	RH.....	Right Hand
&.....	And	G.....	Gram	RPM.....	Revolutions Per Minute
(+).....	Plus	HEX.....	Hexagonal	RR.....	Rear
(-).....	Minus	ID=.....	Inside Diameter	STD.....	Standard
2ND.....	Second	IN.....	Inch	T.....	Teeth
3RD.....	Third	L=.....	Length	T=.....	Thickness
4TH.....	Fourth	LH.....	Left Hand	U/S.....	Under Size
A.....	Ampere	LWR.....	Lower	UPP.....	Upper
AR.....	As Required	MM.....	Millimeter	V.....	Volt
ASSY.....	Assembly	O/S.....	Over Size	W.....	Watt
CNT.....	Center	OD=.....	Outside Diameter		
COMP.....	Complete	REF.....	Reference		

This catalog covers:
FE290D- □ G80

01

This fig. covers:
CYLINDER/CRANKCASE

E0110-A353A

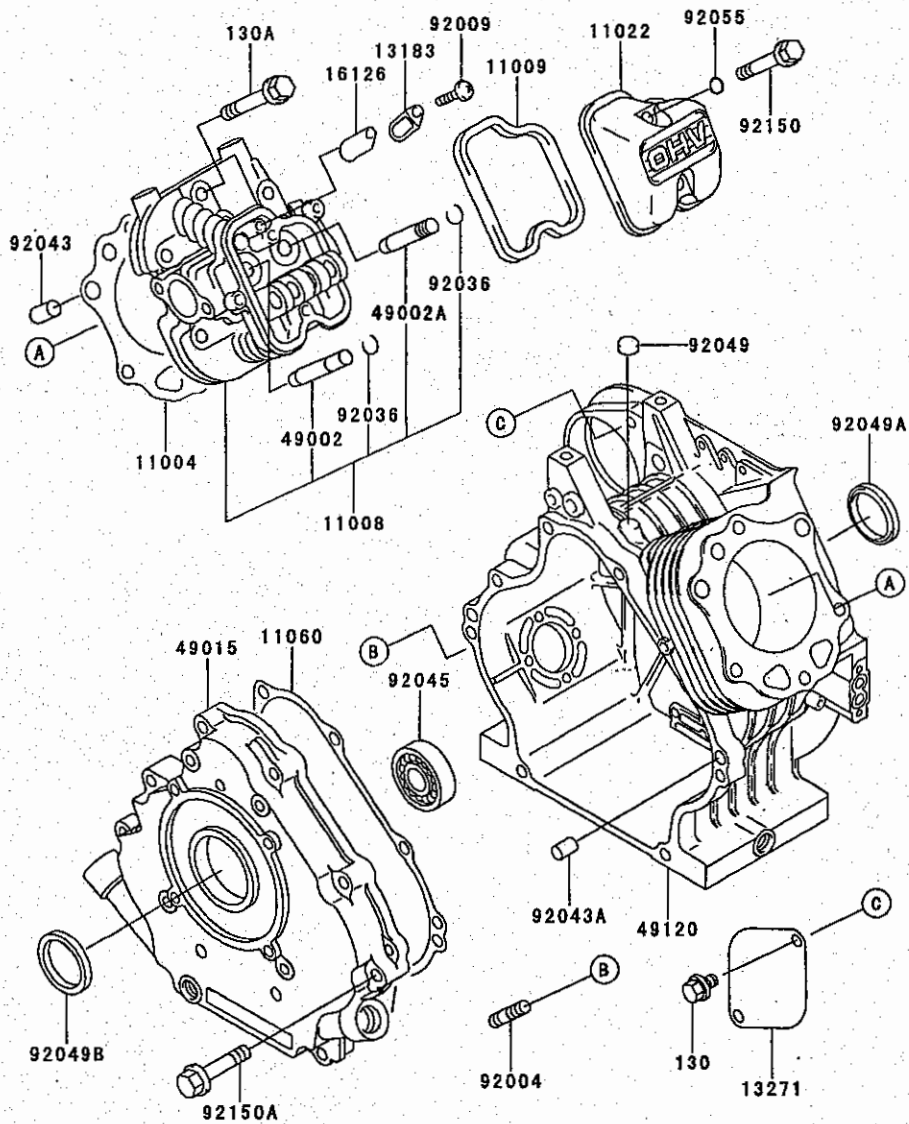

Ref. No.	Part No.	Description	Quantity
11004	11004-2138	GASKET-HEAD	1
11008	11008-2128	HEAD-COMP-CYLINDER	1
11009	11009-2829	GASKET,ROCKER CASE	1
11022	11022-6001	CASE-ROCKER	1
11060	11060-2122	GASKET,CRANKCASE COVER	1
13183	13183-2299	PLATE	1
13271	13271-2170	PLATE	1
16126	16126-2107	VALVE	1
49002	49002-2090	GUIDE-VALVE	1
49002A	49002-2101	GUIDE-VALVE	1
49015	49015-6238	COVER-CRANKCASE	1
49120	49120-2278	CRANKCASE-COMP	1
92004	92004-2083	STUD,6X14	4
92009	92009-2308	SCREW	1
92036	92036-023	RING-SNAP	2
92043	92043-1037	PIN	2
92043A	92043-1263	PIN	2
92045	92045-2168	BEARING-BALL,6306JRCM	1
92049	92049-2097	SEAL-OIL	1
92049A	92049-2199	SEAL-OIL	1
92049B	92049-2220	SEAL-OIL	1
92055	92055-1343	RING-O	2
92150	92150-2145	BOLT,6X35	2
92150A	92150-2252	BOLT,8X45	8
130	130G0812	BOLT-FLANGED	2
130A	130T0845	BOLT-FLANGED	6

E0120-A067B

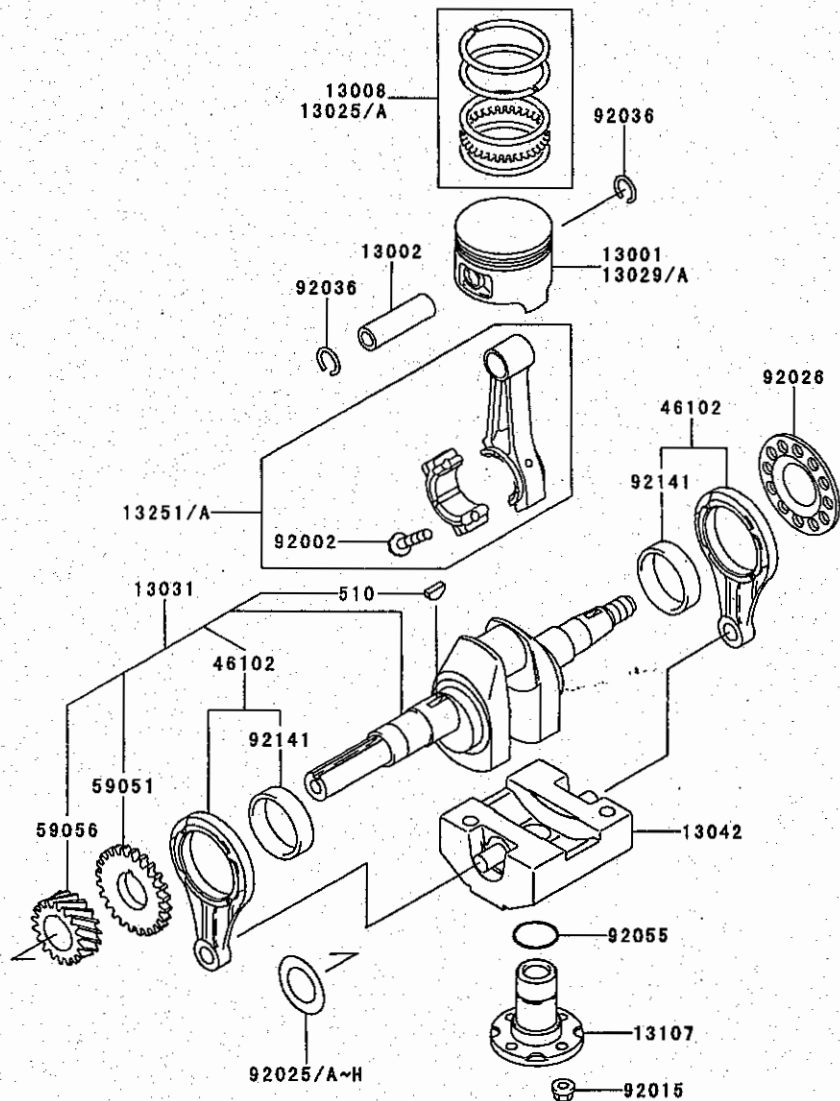

Ref. No.	Part No.	Description	Quantity
13001	13001-2125	PISTON-ENGINE	1
13002	13002-2069	PIN-PISTON	1
13008	13008-6007	RING-SET-PISTON	1
13025	13025-2073	RING-SET-PISTON L,0.25	AR
13025A	13025-2074	RING-SET-PISTON L,0.50	AR
13029	13029-2100	PISTON-ENGINE L,0.25	AR
13029A	13029-2101	PISTON-ENGINE L,0.50	AR
13031	13031-2068	CRANKSHAFT-COMP	1
13042	13042-6009	WEIGHT	1
13107	13107-2088	SHAFT	1
13251	13251-6034	ROD-ASSY-CONNECTING,U/S=0.50	AR
13251A	13251-6056	ROD-ASSY-CONNECTING	1
46102	46102-6004	ROD	2
59051	59051-2097	GEAR-SPUR	1
59056	59056-2993	GEAR-HELICAL	1
92002	92002-2053	BOLT	2
92015	92015-1193	NUT	4
92025	92025-2168	SHIM,T=1.13	AR
92025A	92025-2169	SHIM,T=1.18	AR
92025B	92025-2170	SHIM,T=1.23	AR
92025C	92025-2171	SHIM,T=1.28	AR
92025D	92025-2172	SHIM,T=1.33	AR
92025E	92025-2173	SHIM,T=1.38	AR
92025F	92025-2174	SHIM,T=1.43	AR
92025G	92025-2175	SHIM,T=1.48	AR
92025H	92025-2207	SHIM,T=1.53	AR
92026	92026-2052	SPACER	1
92036	92036-008	RING-SNAP	2
92055	92055-2072	RING-O	1
92141	92141-2090	BEARING-PLANE	2
510	510A5100	KEY-WOODRUFF	1

E0130-A049A

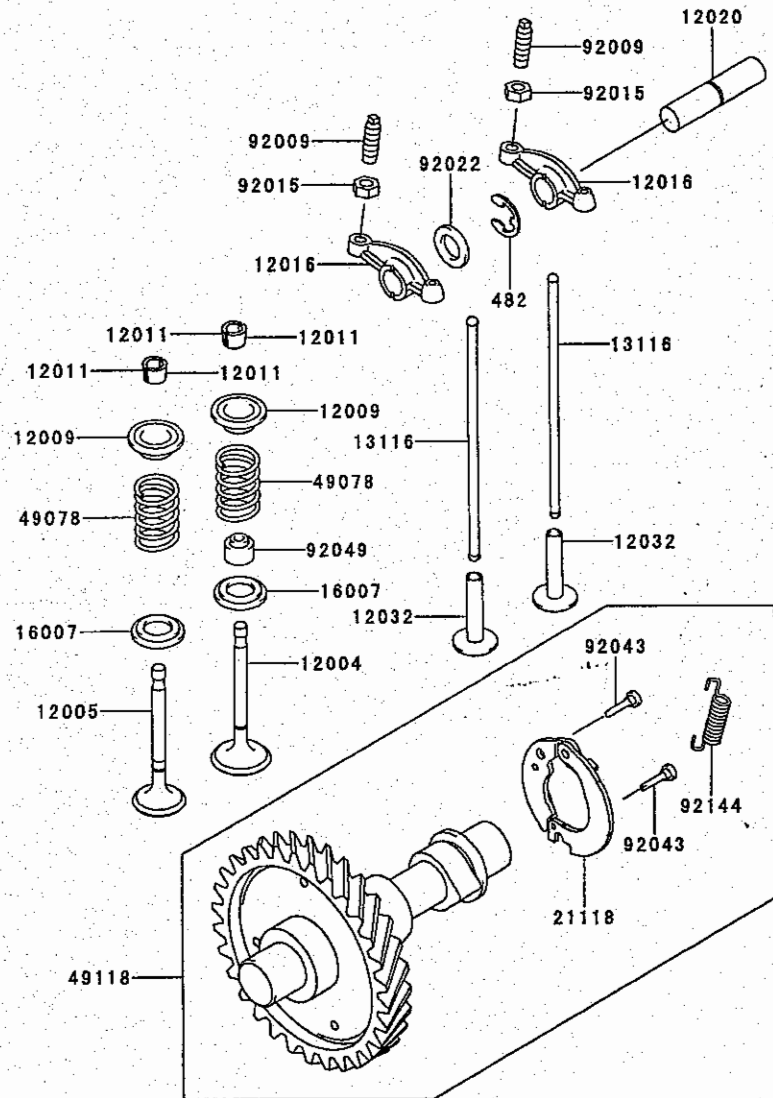

Ref. No.	Part No.	Description	Quantity
12004	12004-2084	VALVE-INTAKE	1
12005	12005-2077	VALVE-EXHAUST	1
12009	12009-2060	RETAINER-VALVE SPRING	2
12011	12011-2052	COLLET	4
12016	12016-2058	ARM-ROCKER	2
12020	12020-2060	SHAFT-ROCKER	1
12032	12032-2060	TAPPET	2
13116	13116-2054	ROD-PUSH	2
16007	16007-2052	SEAT-SPRING	2
21118	21118-2088	DECOMPRESSOR	1
49078	49078-2060	SPRING-ENGINE VALVE	2
49118	49118-2121	CAMSHAFT-COMP	1
92009	92009-1109	SCREW	2
92015	92015-1137	NUT	2
92022	92022-2397	WASHER,12.1X19X1.6	1
92043	92043-2113	PIN	2
92049	92049-2100	SEAL-OIL	1
92144	92144-2323	SPRING	1
482	482J0100	CIRCLIP-TYPE-E	1

This catalog covers:
FE290D- □ G80

This fig. covers:
04 LUBRICATION-EQUIPMENT

E0140-A172A

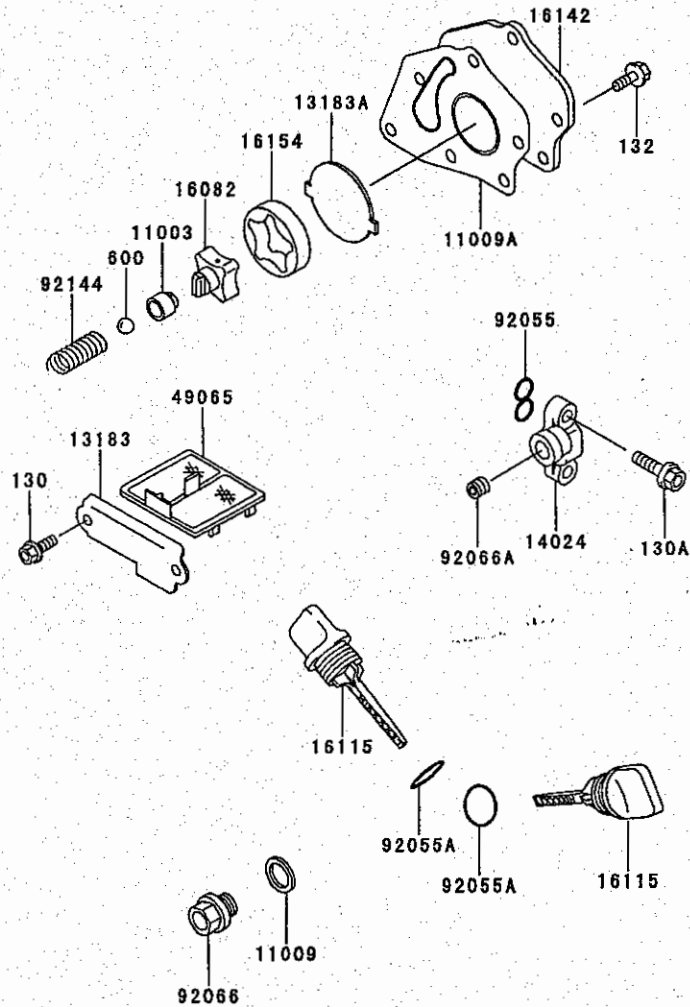

Ref. No.	Part No.	Description	Quantity
11003	11003-2089	SEAT-VALVE	1
11009	11009-2175	GASKET	1
11009A	11009-2828	GASKET,OIL PUMP	1
13183	13183-2295	PLATE,OIL FILTER	1
13183A	13183-2298	PLATE,OIL PUMP	1
14024	14024-2228	COVER	1
16082	16082-2062	PUMP-ASSY-OIL	1
16115	16115-2079	CAP-OIL FILLER	2
16142	16142-2062	COVER-PUMP	1
16154	16154-2054	ROTOR-PUMP,OUT	1
49065	49065-2068	FILTER-OIL	1
92055	92055-2063	RING-O	1
92055A	92055-2185	RING-O,20MM	2
92066	92066-2203	PLUG,DRAIN	1
92066A	92066-2211	PLUG	1
92144	92144-2202	SPRING	1
130	130B0508	BOLT-FLANGED	2
130A	130G0620	BOLT-FLANGED	2
132	132G0612	BOLT-FLANGED-SMALL	6
600	600A1000	BALL-STEEL	1

This catalog covers:

FE290D- □ G80

This fig. covers:

05 COOLING-EQUIPMENT

E0150-A388A

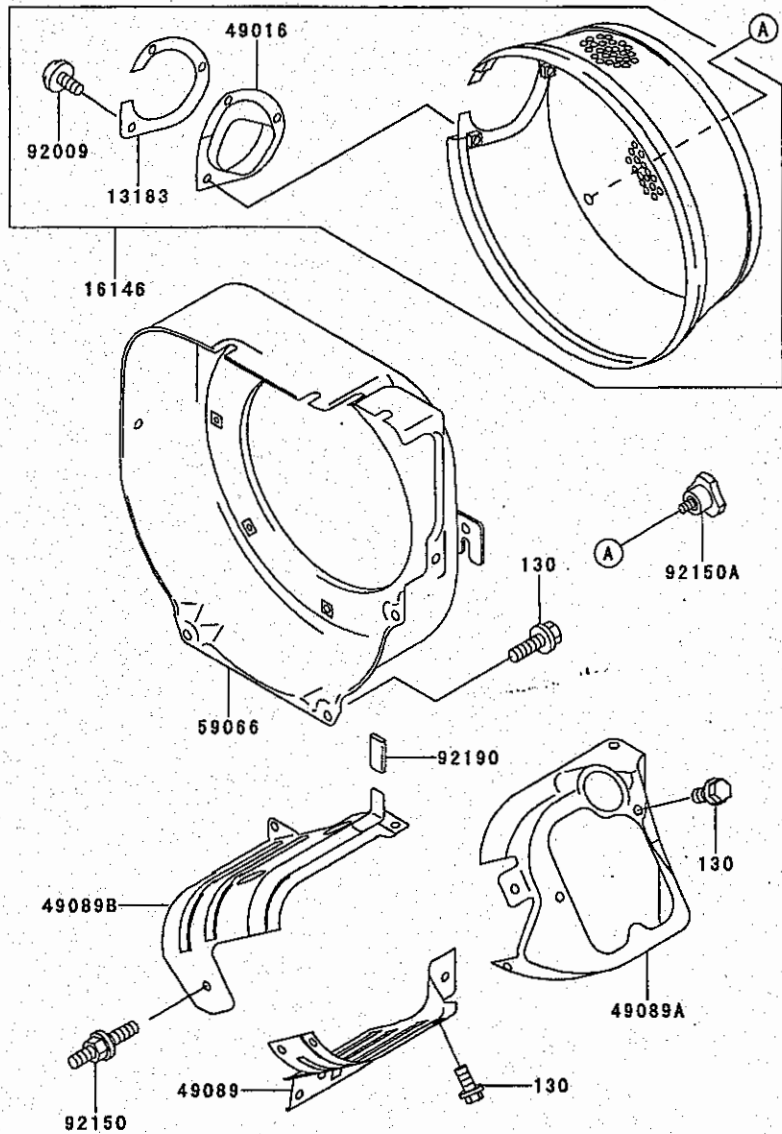

Ref. No.	Part No.	Description	Quantity
13183	13183-2483	PLATE	1
16146	16146-2193	COVER-ASSY	1
49016	49016-2082	COVER-SEAL	1
49089	49089-2309-9H	SHROUD-ENGINE	1
49089A	49089-2317-9H	SHROUD-ENGINE	1
49089B	49089-2318-9H	SHROUD-ENGINE	1
59066	59066-2538-9H	HOUSING-FAN	1
92009	92009-2243	SCREW,5X10	3
92150	92150-2197	BOLT	1
92150A	92150-2264	BOLT	4
92190	92190-2042	TUBE	1
130	130G0612	BOLT-FLANGED	15

E0160-A738A

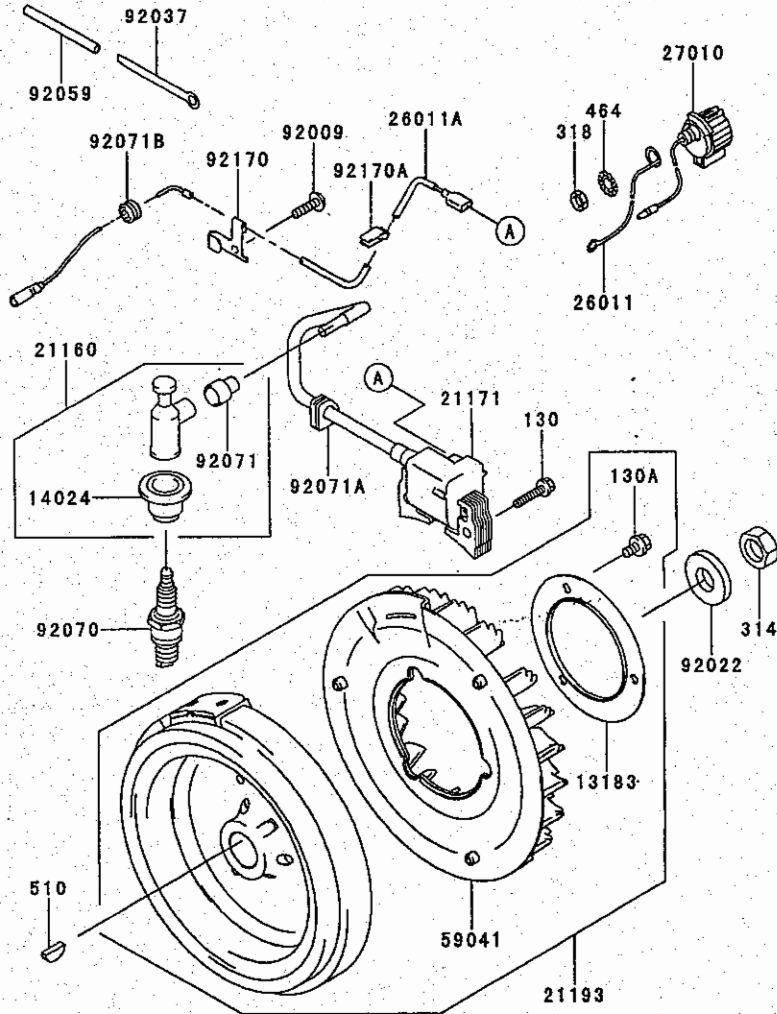

Ref. No.	Part No.	Description	Quantity
13183	13183-2407	PLATE	1
14024	14024-2234	COVER	1
21160	21160-2051	CAP-ASSY-PLUG	1
21171	21171-2207	COIL-ASSY-IGNITION	1
21193	21193-2161	FLYWHEEL-ASSY	1
26011	26011-2266	WIRE-LEAD	1
26011A	26011-2359	WIRE-LEAD	1
27010	27010-2066	SWITCH	1
59041	59041-2082	FAN	1
92009	92009-2308	SCREW	1
92022	92022-2205	WASHER	1
92037	92037-2006	CLAMP	1
92059	92059-2011	TUBE,5X6X75	1
92070	92070-2077	PLUG-SPARK,BPR5ES(NGK),SOLID	1
92071	92071-2008	GROMMET	1
92071A	92071-2112	GROMMET	1
92071B	92071-2125	GROMMET	1
92170	92170-2016	CLAMP	1
92170A	92170-2017	CLAMP	1
130	130B0525	BOLT-FLANGED	2
130A	130G0610	BOLT-FLANGED	3
314	314G1600	NUT-HEX-FINE	1
318	318B0800	NUT-HEX-SMALL	1
464	464H0800	WASHER-TOOTHED	1
510	510A5100	KEY-WOODRUFF	1

This catalog covers:
FE290D- □ G80

This fig. covers:
07 CONTROL-EQUIPMENT

E0170-A021G

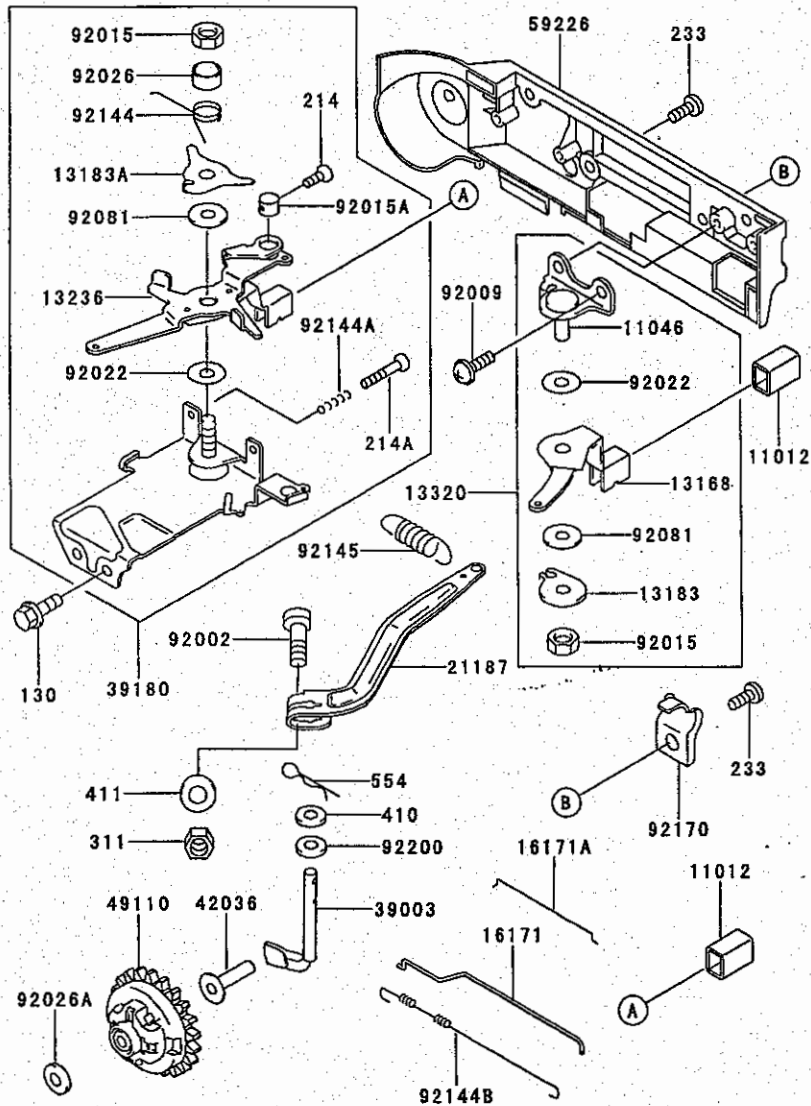

Ref. No.	Part No.	Description	Quantity
11012	11012-2282	CAP	2
11046	11046-2143	BRACKET	1
13168	13168-2314	LEVER	1
13183	13183-2334	PLATE	1
13183A	13183-2343	PLATE	1
13236	13236-2116	LEVER-COMP	1
13320	13320-2021	LEVER-ASSY	1
16171	16171-2061	LINK, THROTTLE	1
16171A	16171-2062	LINK	1
21187	21187-2061	ARM-ASSY	1
39003	39003-2076	ARM-PIVOT	1
39180	39180-2643	PANEL-ASSY-CONTROL	1
42036	42036-2060	SLEEVE	1
49110	49110-2069	GOVERNOR-ASSY	1
59226	59226-2229	PANEL-CONTROL	1
92002	92002-2269	BOLT	1
92009	92009-2203	SCREW	2
92015	92015-2051	NUT	2
92015A	92015-2120	NUT	1
92022	92022-2103	WASHER	2
92026	92026-2304	SPACER	1
92026A	92200-2036	SPACER	1
92081	92081-2104	SPRING	2
92144	92144-2257	SPRING	1
92144A	92144-2266	SPRING	2
92144B	92144-2340	SPRING	1
92145	92145-2054	SPRING	1
92170	92170-2035	CLAMP	1
92200	92200-2029	WASHER, 6.5X11.5X2.0	1
130	130G0612	BOLT-FLANGED	2
214	214B0408	SCREW-PAN+-	1
214A	214B0422	SCREW-PAN+-	2
233	233C0514	SCREW-PAN-WP+-	4
311	311B0600	NUT-HEX	1
410	410B0600	W-PLAIN-S	1
411	411B0600	WASHER-PLAIN	1
554	554A0600	PIN-SNAP	1

E0180-A455A

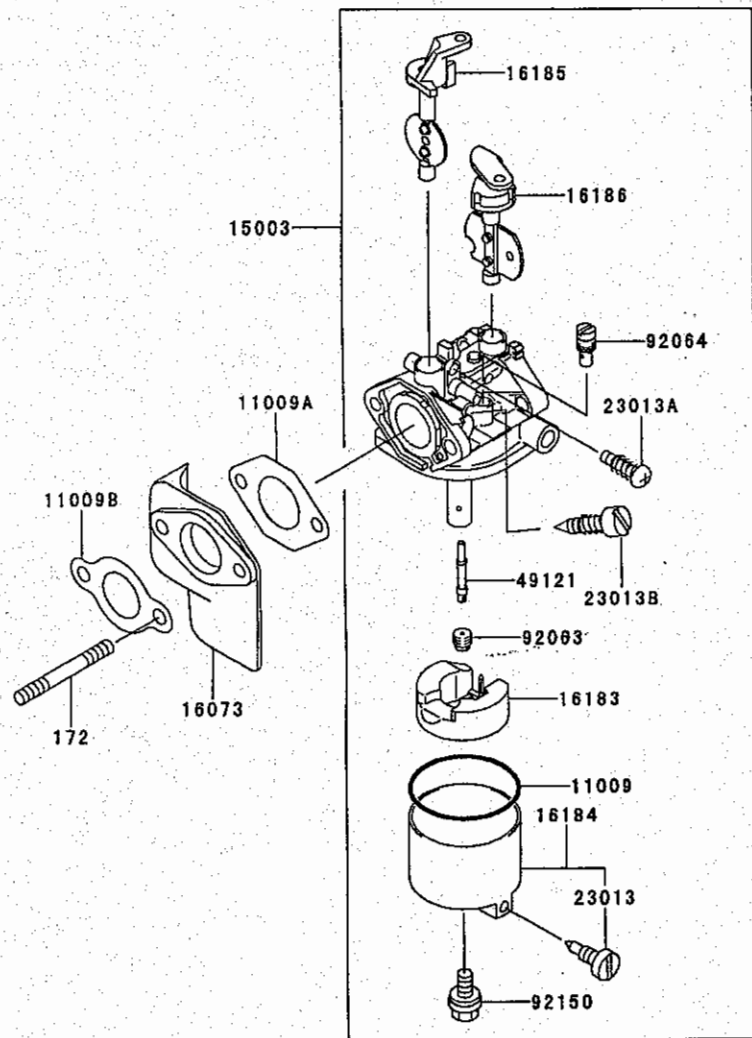

Ref. No.	Part No.	Description	Quantity
11009	11009-2919	GASKET	1
11009A	11009-2928	GASKET,CARBURETOR	1
11009B	11009-2939	GASKET,INSULATOR	1
15003	15003-2385	CARBURETOR-ASSY	1
16073	16073-2154	INSULATOR	1
16183	16183-2005	FLOAT-ASSY	1
16184	16184-2002	CHAMBER-ASSY-FLOAT	1
16185	16185-2008	VALVE-ASSY-THROTTLE	1
16186	16186-2018	VALVE-ASSY-CHOKE	1
23013	23013-2053	SCREW-ASSY	1
23013A	23013-2054	SCREW-ASSY	1
23013B	23013-2055	SCREW-ASSY	1
49121	49121-2193	NOZZLE-MAIN	1
92063	92063-2243	JET-MAIN,#90	1
92064	92064-2083	JET-PILOT,#45	1
92150	92150-2209	BOLT	1
172	172G0675	BOLT-STUD	2

E0190-A486A

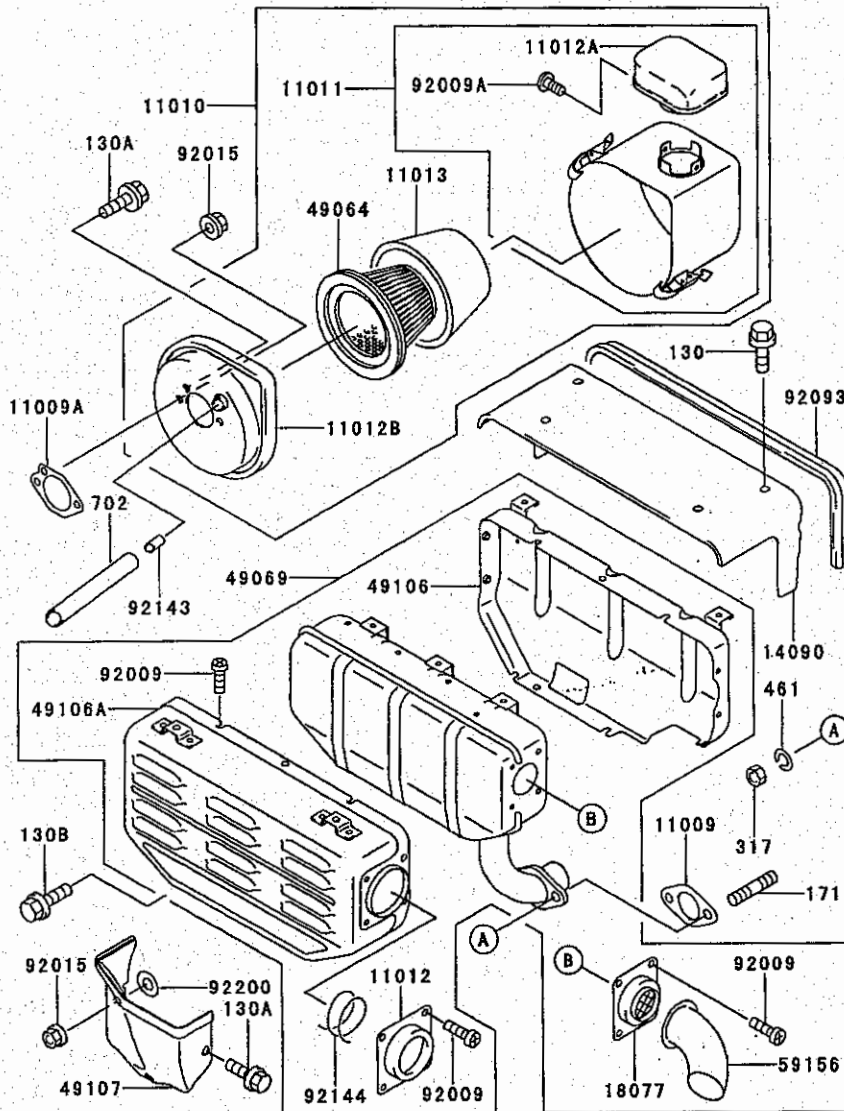

Ref. No.	Part No.	Description	Quantity
11009	11009-2487	GASKET,MUFFLER	1
11009A	11009-2925	GASKET,AIR FILTER	1
11010	11010-2474-9H	FILTER-ASSY-AIR	1
11011	11011-2247-9H	CASE-AIR FILTER	1
11012	11012-2322-9X	CAP	1
11012A	11012-2357	CAP,AIR FILTER	1
11012B	11012-2358	CAP,AIR FILTER	1
11013	11013-2159	ELEMENT-AIR FILTER	1
14090	14090-2019-9H	COVER	1
18077	18077-2094	ARRESTER-SPARK	1
49064	49064-2077	FILTER-AIR	1
49069	49069-2275	MUFFLER-ASSY	1
49106	49106-2514-9X	COVER-MUFFLER	1
49106A	49106-2549-9X	COVER-MUFFLER	1
49107	49107-2140-9H	COVER-EXHAUST PIPE	1
59156	59156-2230-9Y	PIPE-TAIL	1
92009	92009-2322	SCREW	15
92009A	92009-2388	SCREW	2
92015	92015-1193	NUT	3
92093	92093-2094	SEAL	1
92143	92143-2207	COLLAR,6.0X8.0X25	1
92144	92144-2262	SPRING	1
92200	92200-2070	WASHER	1
130	130B0508	BOLT-FLANGED	4
130A	130G0612	BOLT-FLANGED	3
130B	130G0816	BOLT-FLANGED	1
171	171G0820	BOLT-STUD	2
317	317R0800	NUT-HEX-SMALL	2
461	461F0800	WASHER-SPRING	2
702	702A081000	TUBE-RUBBER	1

E0200-A003E

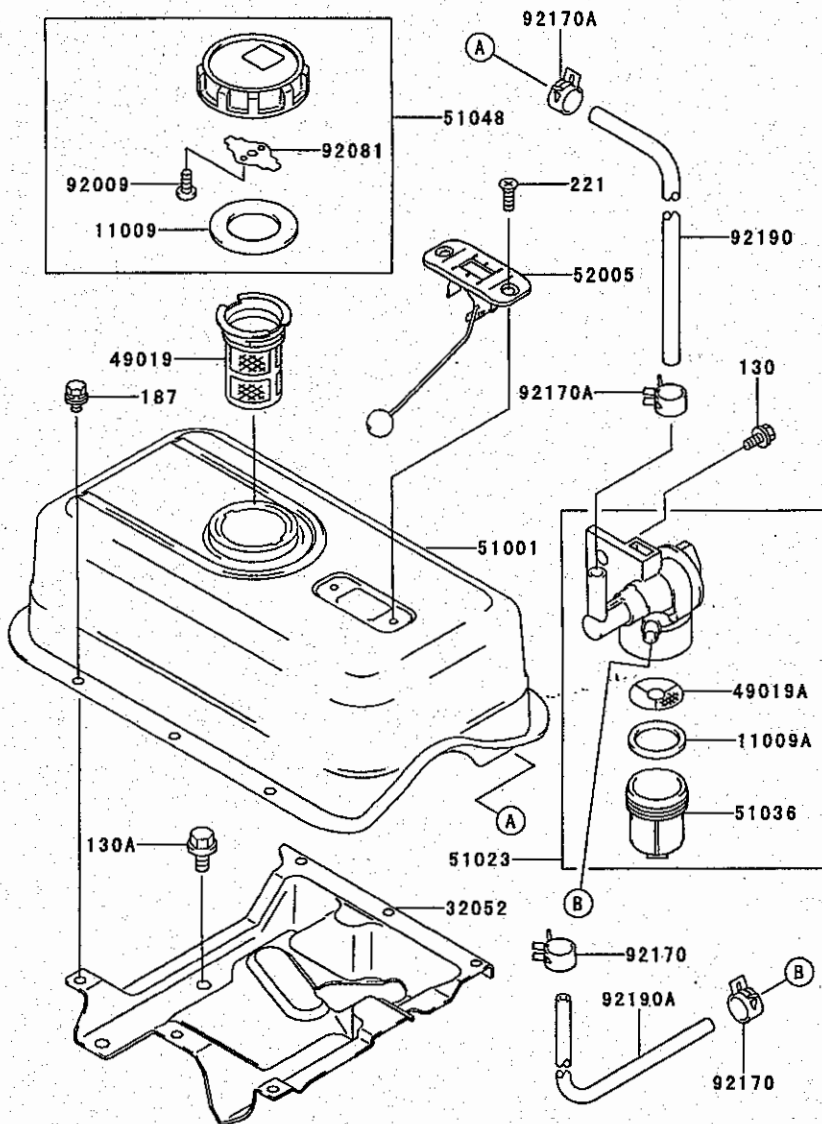

Ref. No.	Part No.	Description	Quantity
11009	11009-2115	GASKET	1
11009A	11009-2876	GASKET,FUEL TAP	1
32052	32052-2199-9H	BRACKET-TANK	1
49019	49019-2051	FILTER-FUEL	1
49019A	49019-2095	FILTER-FUEL	1
51001	51001-2222-9H	TANK-COMP-FUEL	1
51023	51023-2148	TAP-ASSY	1
51036	51036-2071	CUP,FUEL TAP	1
51048	51048-2055	CAP-ASSY-TANK	1
52005	52005-2100	GAUGE	1
92009	92009-2021	SCREW	2
92081	92081-2036	SPRING	1
92170	92170-2042	CLAMP	2
92170A	92170-2082	CLAMP	2
92190	92190-2073	TUBE,7X12X205	1
92190A	92190-2118	TUBE,6X10X120	1
130	130G0612	BOLT-FLANGED	1
130A	130G0816	BOLT-FLANGED	4
187	187J0612	BOLT-UPSET-WSP	6
221	221C0512	SCREW-CSK-CROS	2

E0210-A238A

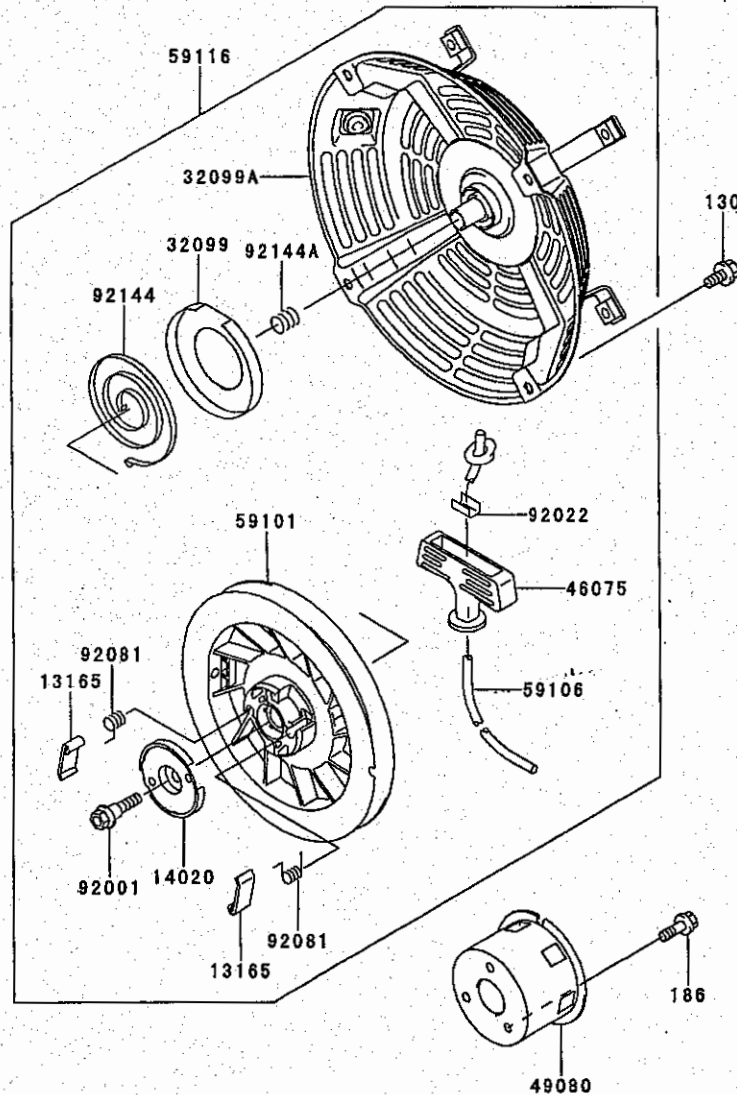

Ref. No.	Part No.	Description	Quantity
13165	13165-2073	PAWL,RECOIL STARTER	2
14020	14020-2094	RETAINER,RECOIL STARTER	1
32099	32099-2193	CASE,SPRING	1
32099A	32099-2355-YK	CASE,RECOIL STARTER	1
46075	46075-2092	GRIP,RECOIL STARTER	1
49080	49080-2154	PULLEY-STARTING	1
59101	59101-2092	REEL,RECOIL STARTER	1
59106	59106-2099	ROPE,4.5X1550	1
59116	59116-2344-YK	STARTER-ASSY-RECOIL	1
92001	92001-2027	BOLT	1
92022	92022-2248	WASHER	1
92081	92081-2021	SPRING	2
92144	92144-2055	SPRING,RECOIL	1
92144A	92144-2212	SPRING	1
130	130G0612	BOLT-FLANGED	4
186	186B0610	BOLT-UPSET-WP	3

This catalog covers:
FE290D- □ G80

12

This fig. covers:
LABEL

F0290-A856A

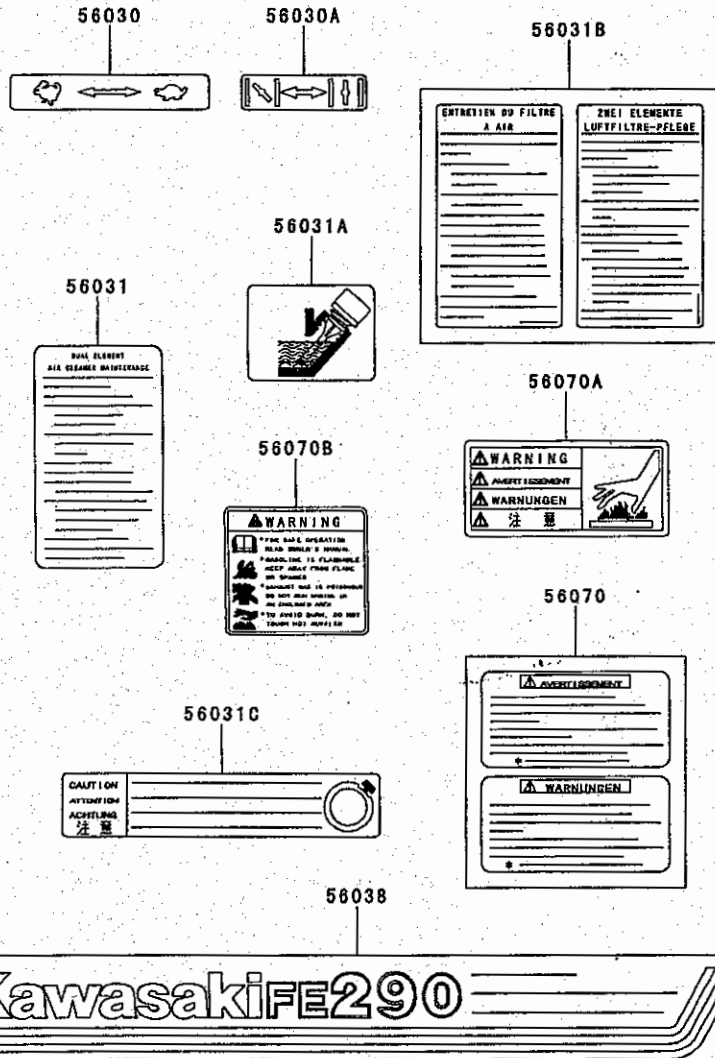

Ref. No.	Part No.	Description	Quantity
56030	56030-2385	LABEL, THROTTLE	1
56030A	56030-2386	LABEL, CHOKE	1
56031	56031-2387	LABEL-MANUAL	1
56031A	56031-2458	LABEL-MANUAL	1
56031B	56031-2461	LABEL-MANUAL	1
56031C	56031-2465	LABEL-MANUAL	1
56038	56038-2671	LABEL-BRAND	1
56070	56070-2003	LABEL-WARNING	1
56070A	56070-2010	LABEL-WARNING	1
56070B	56070-2066	LABEL-WARNING	1

This catalog covers:
FE290D- □ G80

13

This fig. covers:
TOOL

F0300-A001A

Ref. No.	Part No.	Description	Quantity
56007	56007-2051	TOOLKIT	1
92107	92107-2057	TOOL-DRIVER	1
92110	92110-2051	TOOL-WRENCH,19X21	1

